



## HOW TO ADJUST T400 SERIES LATCH FROM 2 3/4" TO 2 3/8" OR VICE VERSA.

1. 2 3/4" Backset



2. Throw the bolt using a flathead screwdriver.



3. Turn to the direction as shown.

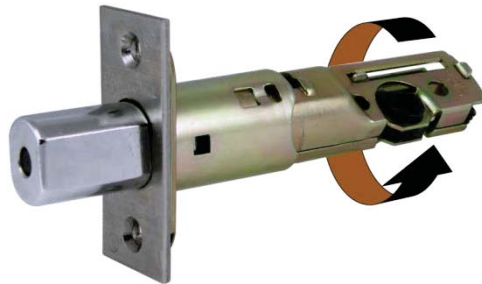

4. Push front and back portion towards each other.

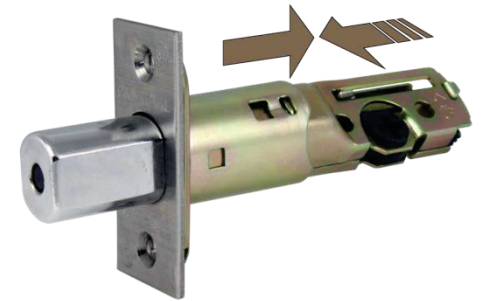

5. Turn to the direction as shown.



6. Retract the bolt. Latch is now 2 3/8" backset.

