

**INSTALLATION INSTRUCTIONS**  
**Summit Leversets**  
**Argo Series Privacy / Passage**

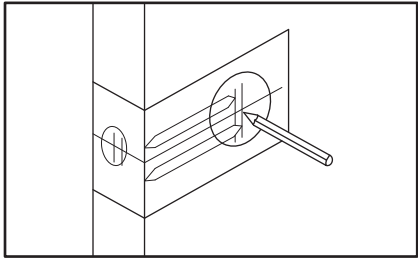

**1. Mark door with template.**

- a. Start 36" (914mm) from floor or as desired. Fold and apply template and mark center of door edge.
- b. Select 2-3/8" or 2-3/4" (60mm or 70mm) backset as desired and mark center of hole on door face.

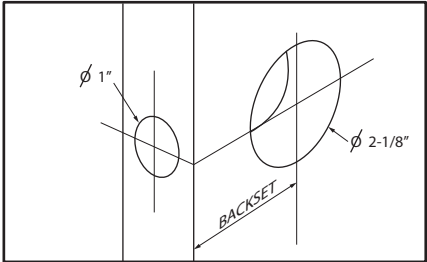

**2. Drill Holes.**

- a. Drill 2-1/8" (54mm) hole on door face, from both sides to avoid wood splitting.
- b. Drill 1" (25.4mm) hole for latch

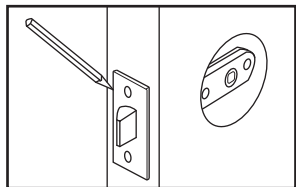

**3. Install Latch**

- a. Insert latch into hole and mark outline of faceplate.

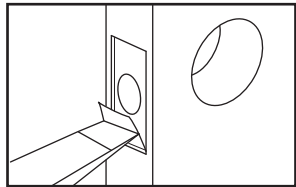

- b. Chisel 1/8" (3mm) deep.

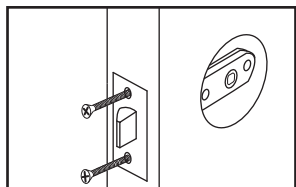

- c. Insert latch and tighten screw.

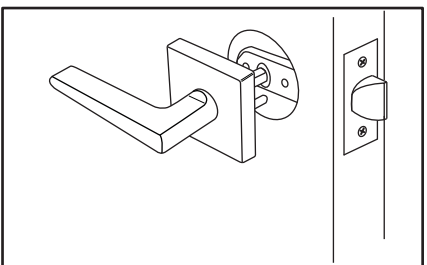

**4. Install outside knob or lever**

- a. Insert spindle through latch. Press flush against door.

NOTE: Keyhole must be in down position.

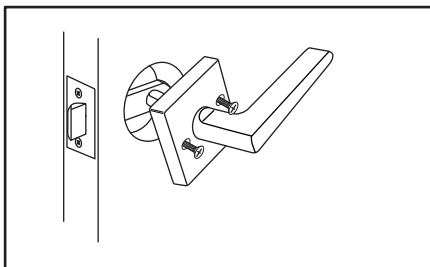

**5. Install inside knob or lever**

- a. Install inside knob and at the same time align holes for the screws.
- b. Tighten screws until lock is firm.

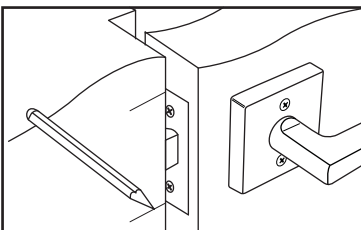

**6. Install strike.**

- a. Close door to make horizontal line of strike on the jamb.

- b. Measure 1/2 of door thickness from door stop and mark vertical center line of strike.

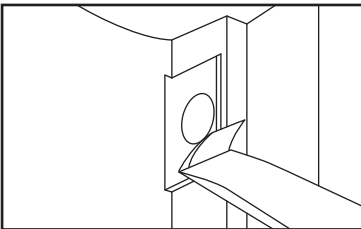

- c. Drill 1" (25.4mm) hole 1/2" (13mm) deep at intersection of horizontal and vertical line of strike.

- d. Match screw holes on strike with center lines on jamb.

- e. Mark outline and chisel 1/16" (1.6mm) deep for stike.

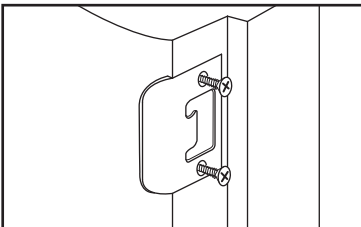

- f. Install strike and tighten screws.