

CYLINDER DOGGING KIT EXPLODED VIEW

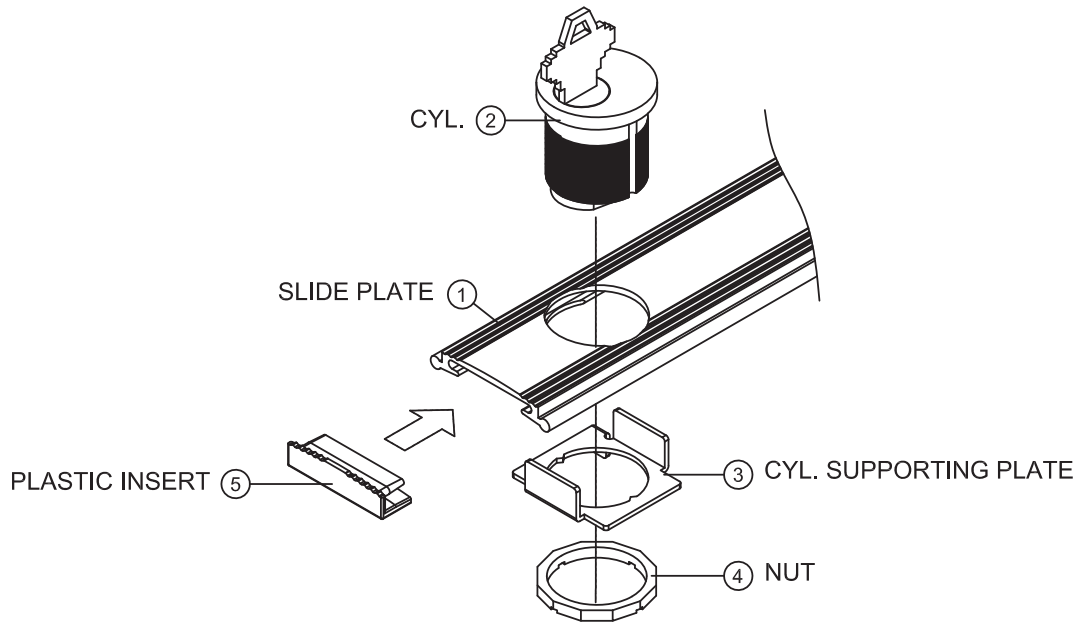

CYLINDER DOGGING KIT ASSEMBLED

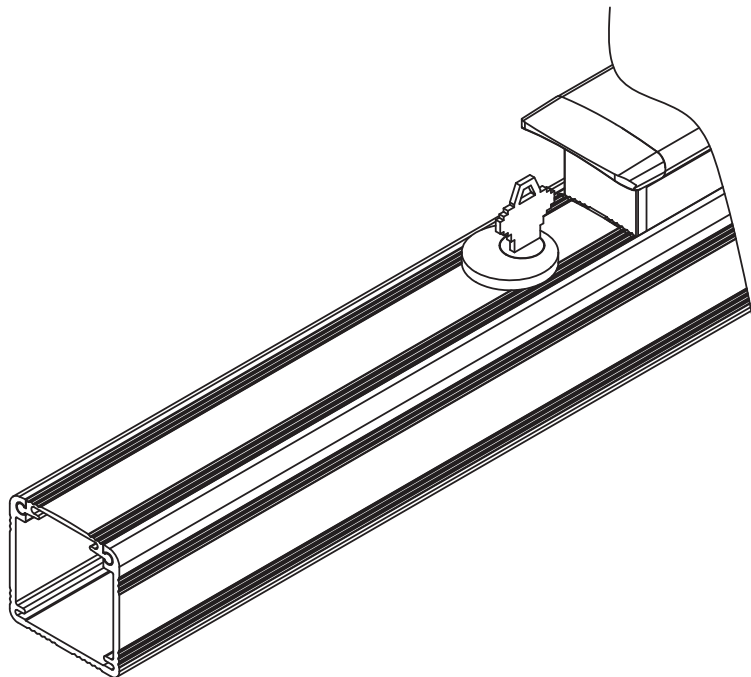

1. UNFASTEN THE SCREW THAT SECURES THE DOGGING KIT.

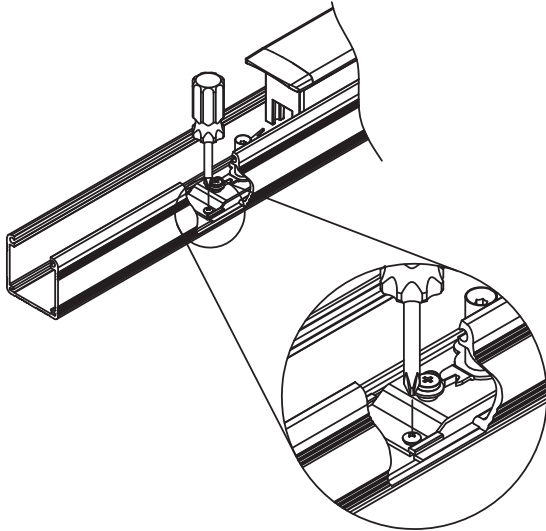

4. PLACE NO.9 SECURED SEAT , NO.8 TURN PLATE, AND NO.7 WASHER, AND SECURE BY NO.6 SCREW.

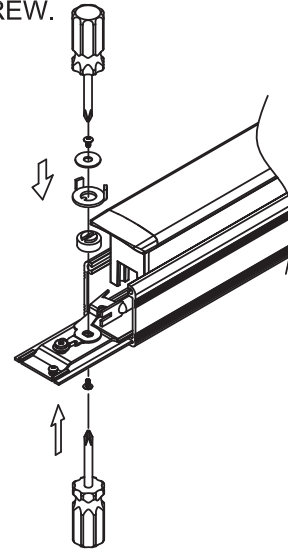

2. SLIDE OUT THE DOGGING KIT 3" OUT OF MOUNTING RAIL.

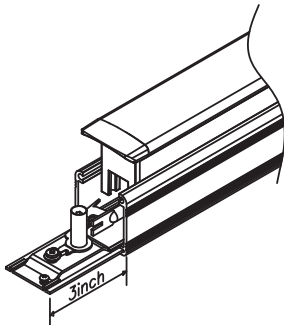

5. PRESS FIT NO.13 S SPRING TO CLICK TO DOGGING PLATE.

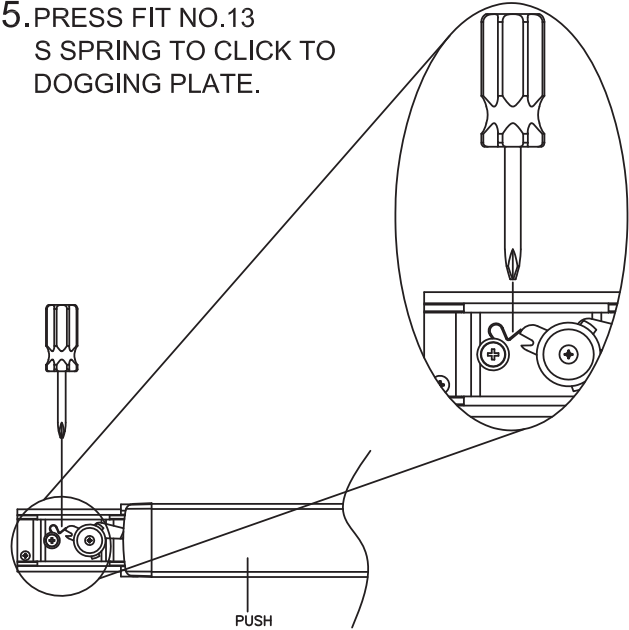

3. UNFASTEN HEX SET STUD BY UNSCREWING NO.6 SCREW.

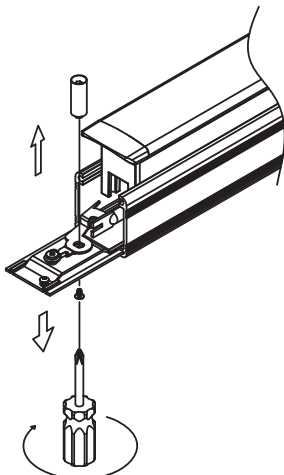

6. RE-SECURE THE CYLINDER DOGGING KIT TO THE MOUNTING RAIL.

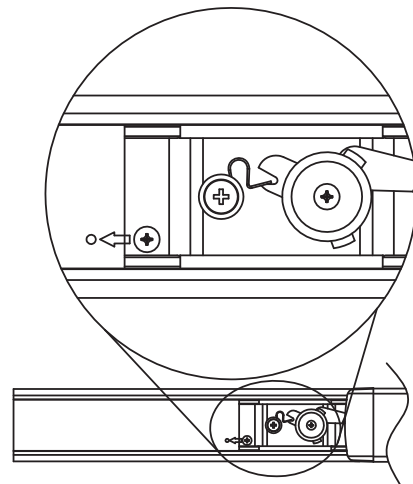

PARTS NUMBER

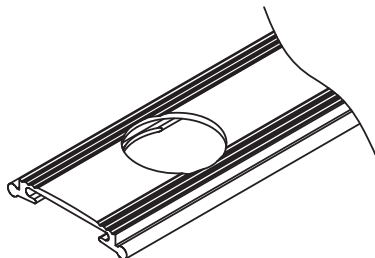

① SLIDE PLATE

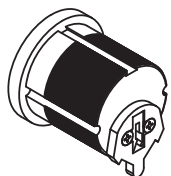

② CYLINDER

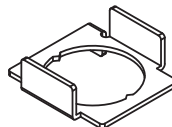

③ CYLINDER SUPPORTING PLATE

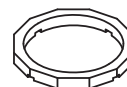

④ NUT

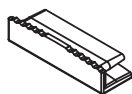

⑤ PLASTIC INSERT



⑥ SCREWS

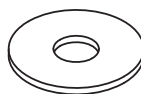

⑦ WASHER

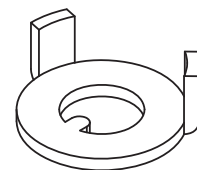

⑧ TURN PLATE

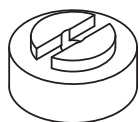

⑨ SECURED SEAT



⑩ FASTENER FOR S SPRING



⑪ WASHER FOR S SPRING



⑫ S SPRING

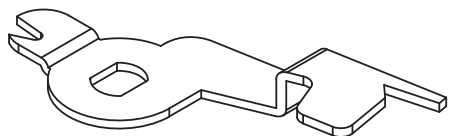

⑬ DOGGING PLATE



⑭ CAM

CAM ASSEMBLY

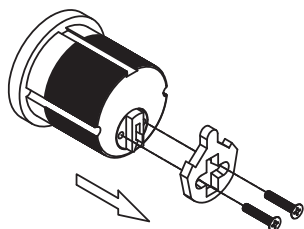
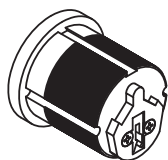

UNSCREW SHORT CAM

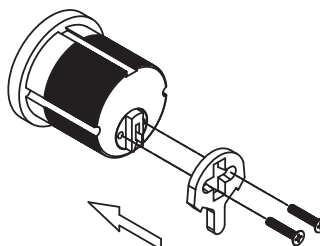

RE-SCREW LONG CAM

