

GENESYS

CLUTCH MECHANISM

FIXED THRU BOLT INSTALLATION

Interchangeable Core for BEST, FALCON & ARROW

LIFETIME
WARRANTY

BHMATM
CERTIFIED
Be Safe. Be Secure. Look for the Mark.

MEETS
The Buy American Act



Meets ADA requirements
Specially designed for
Barrier Free Application
Conforms with BHMA / ANSI A156.2
Series 4000, Grade 1 requirements
Exceeds 1,000,000 cycles



CLUTCH

Free turning handle in the locked position, without retracting the latch to help prevent breaking of handle

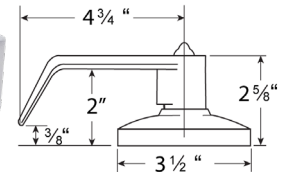

GN DESIGN



SPA DESIGN

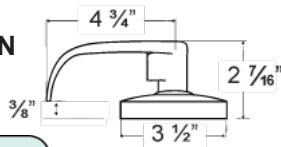

AT DESIGN

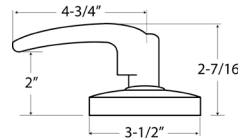

TUB DESIGN

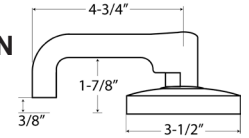

SPECIFICATIONS

GENERAL

Full length 4 3/4" lever handle with 3/8" return on GN and SPA Design. Rose diameter 3 1/2". Key removable outside lever for fast re-keying. Non-handed levers. Concealed mounting screws.

CLUTCH

Free turning handle in the lock position without retracting the latch, to deter breaking of handle.

APPLICATIONS

For offices, schools, hospitals, apartments, hotel / motel, residential, commercial and public buildings.

DOOR RANGES

1 3/8" to 1 3/4" thickness. 2" to 2 1/4" thickness also available on request.

ANSI STANDARDS

Meets or exceeds BHMA / ANSI A 156.2 Series 4000, grade 1 requirements.

LATCH FACEPLATE

Standard 2 1/4" x 1 1/8" for 2 3/4" backset. Optional 2 1/4" x 1" for 2 3/8" backset.

STRIKES

ASA 1 1/4" x 4 7/8" standard. Other strikes available upon request.

CYLINDER & KEYWAYS

6 pin solid brass "C" keyway standard. Schlage E, Schlage C-K, Russwin D1-2-3-4, Corbin 59/60, Corbin-Russwin L4, Sargent LA-LB-LC, Falcon / Weiser E, Arrow A, Yale 8, Yale GA and Kwikset. Can also accept Medeco, Assa, Kaba and Cal-Royal (HSK) High Security Cylinders.

TRIM

Thru-bolted assembly through door with separate spring cage for each lever.

HOUSING

Cold Rolled Steel and Zinc Dichromate finish for rust resistance with precision cast steel retractor. 2 1/8" diameter bore.

INTERCHANGEABLE CORE (IC)

Interchangeable Core locks will accept compatible 6 or 7 pin cores with BEST, FALCON and ARROW. Also available with SCHLAGE, CORBIN / RUSSWIN, SARGENT and YALE large format cylinders. For Schlage, Corbin / Russwin, Sargent and Yale format specifications, refer to next page.

LATCH OPTIONS

2 3/4" standard, brass with 1/2" throw. 2 3/8", 3 3/4" and 5" backset optional. GND750 deadlatch reversible for flat and beveled door. 3/4" throw anti-friction deadlatch for pair of fire doors.

ELECTRIFIED LOCKS, TACTILE & LEAD LINING available upon request.